

**FOR INFORMATION ONLY:  
DO NOT MANUFACTURE  
PARTS TO THIS DRAWING**

- NOTES:
- SUBSTRATE  
UV GRADE FUSED SILICA
  - SURFACE S2 TO BE PARALLEL WITH SURFACE S1 TO WITHIN 5 ARCSEC
  - COATING (APPLY ACROSS COATING APERTURE)  
  
PERFORMANCE SPECIFICATIONS @ 0° AOI  
T(AVG): >85% FROM 935 - 2000nm  
T(AVG): < 1% FROM 675 - 855nm  
T(ABS): = 50% @ 900nm  
  
S1: MULTILAYER DIELECTRIC COATING  
S2: SINGLE LAYER MgF2

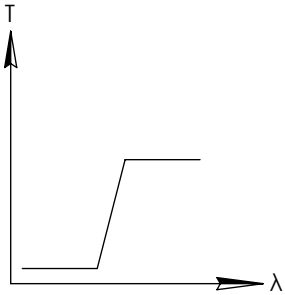
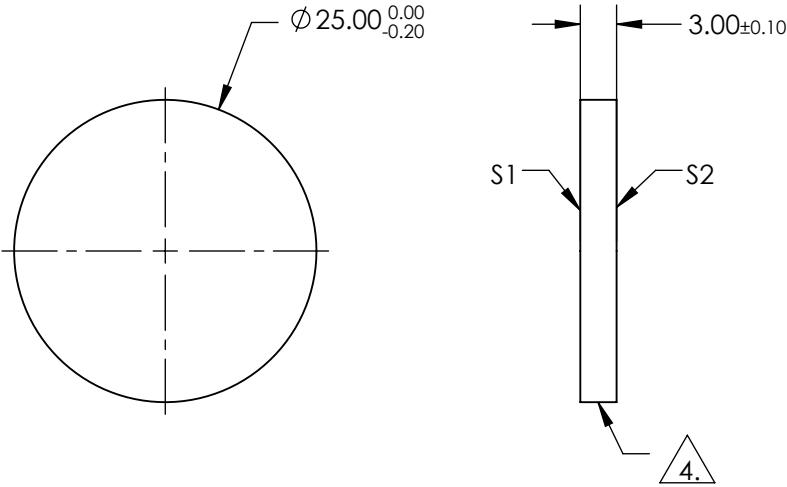
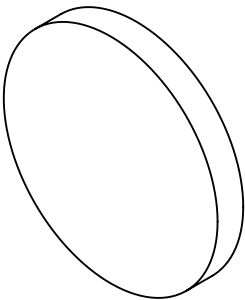

LONGPASS FILTER

SPECIFICATIONS SUBJECT TO CHANGE WITHOUT NOTICE  
DIMENSIONS ARE FOR REFERENCE ONLY

|                  | S1                   | S2                   |
|------------------|----------------------|----------------------|
| SHAPE            | PLANO                | PLANO                |
| SURFACE QUALITY  | 40-20                | 40-20                |
| CLEAR APERTURE   | 80%                  | 80%                  |
| COATING APERTURE | Ø20.00               | Ø20.00               |
| BEVEL            | PROTECTIVE AS NEEDED | PROTECTIVE AS NEEDED |

**Edmund Optics®**



ALL DIMS IN

mm

TITLE

OD2, Ø25mm, 900nm LONGPASS FILTER

DWG NO

48561

SHEET  
1 OF 1