

**FOR INFORMATION ONLY:
DO NOT MANUFACTURE
PARTS TO THIS DRAWING**

- NOTES:
1. SUBSTRATE
UV GRADE FUSED SILICA
 2. SURFACE S2 TO BE PARALLEL WITH SURFACE S1 TO WITHIN 5 ARCSEC
 3. COATING (APPLY ACROSS COATING APERTURE)

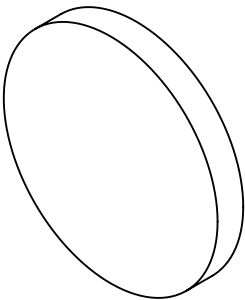

PERFORMANCE SPECIFICATIONS @ 0° AOI
T(AVG): >85% FROM 495 - 2000nm
T(AVG): < 1% FROM 200 - 455nm
T(ABS): = 50% @ 475nm

S1: MULTILAYER DIELECTRIC COATING
S2: SINGLE LAYER MgF2

4. FINE GRIND SURFACE
5. TRANSMITTED WAVEFRONT DISTORTION RMS@ 632.8nm ≤ ¼ WAVE
 6. ROHS COMPLIANT

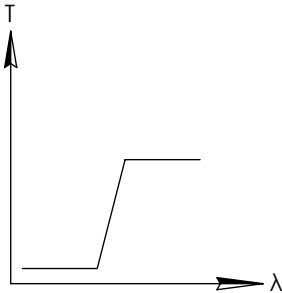
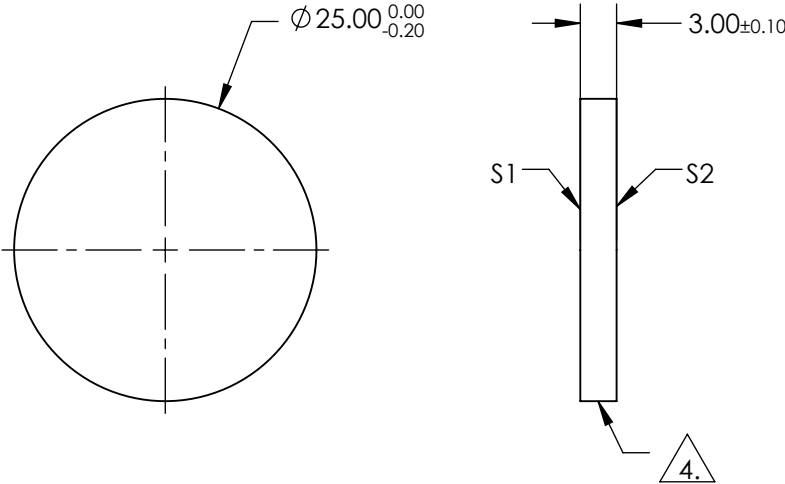

LONGPASS FILTER

SPECIFICATIONS SUBJECT TO CHANGE WITHOUT NOTICE
DIMENSIONS ARE FOR REFERENCE ONLY

	S1	S2
SHAPE	PLANO	PLANO
SURFACE QUALITY	40-20	40-20
CLEAR APERTURE	80%	80%
COATING APERTURE	Ø20.00	Ø20.00
BEVEL	PROTECTIVE AS NEEDED	PROTECTIVE AS NEEDED

Edmund Optics®



ALL DIMS IN

mm

TITLE

OD2, Ø25mm, 475nm LONGPASS FILTER

DWG NO

64625

SHEET
1 OF 1