

NOTES:

1. SUBSTRATE MATERIAL:
BOROFLOAT®
2. CLEAR APERTURE AND COATING APERTURE
ARE CENTERED ON SURFACES
3. COATING (APPLY ACROSS CLEAR APERTURE)
S1: R(avg) > 95% FROM 750-1150nm @ 0° AOI
T(avg) > 92% FROM 425-675nm @ 0° AOI

S2:NONE

4. FINE GRIND SURFACE

5. POWER, IRREGULARITY, AND SURFACE QUALITY
SPECIFICATIONS APPLY ACROSS CLEAR APERTURE
6. ROHS COMPLIANT

**FOR INFORMATION ONLY:
DO NOT MANUFACTURE
PARTS TO THIS DRAWING**

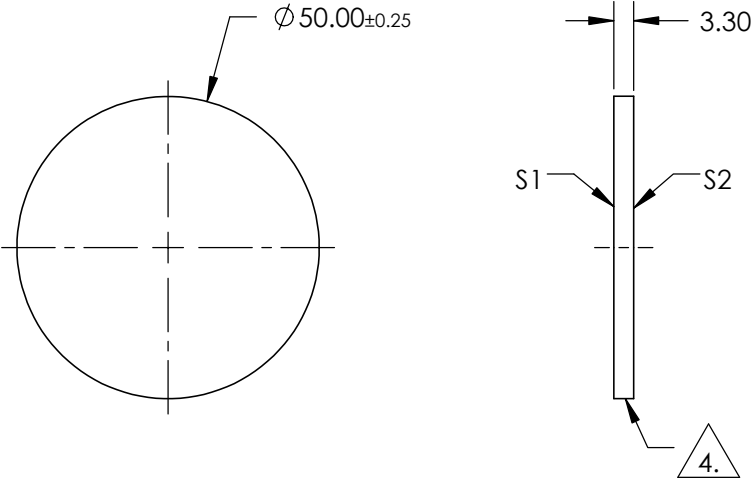

SPECIFICATIONS SUBJECT TO CHANGE WITHOUT NOTICE
DIMENSIONS ARE FOR REFERENCE ONLY

REV. 001	S1	S2	<div><div><div><div><div></div><div></div></div><div>THIRD ANGLE PROJECTION</div></div><div><div>ALL DIMS IN</div><div>mm</div></div></div><div><div><div>Edmund Optics®</div><div>50mm DIA., 0° AOI, HOT MIRROR</div></div><div><div>DWG NO</div><div>54515</div></div><div><div>SHEET</div><div>1 OF 1</div></div></div></div>			
SHAPE	PLANO	PLANO				
SURFACE QUALITY	80-50	80-50				
SURFACE FLATNESS	4 - 6λ	4 - 6λ				
CLEAR APERTURE	Ø42.5	Ø42.5				
BEVEL	PROTECTIVE AS NEEDED	PROTECTIVE AS NEEDED				