

NOTES:
1. SUBSTRATE:
THALLIUM BROMOIODIDE

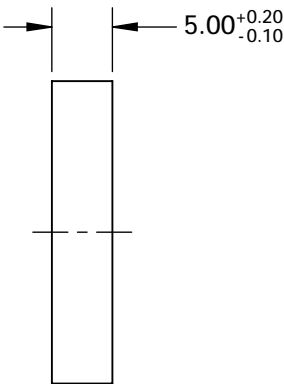
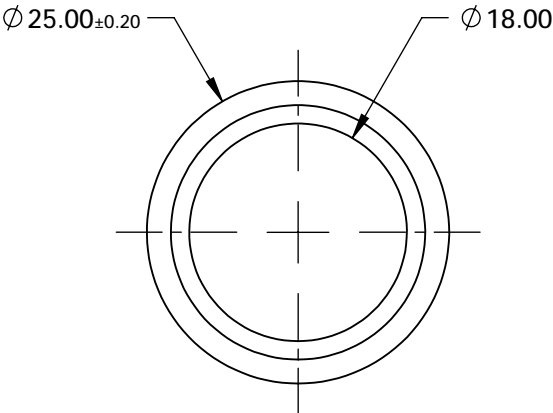
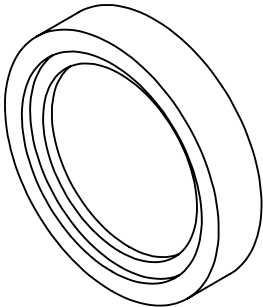

**FOR INFORMATION ONLY:
DO NOT MANUFACTURE
PARTS TO THIS DRAWING**

SPECIFICATIONS SUBJECT TO CHANGE WITHOUT NOTICE
DIMENSIONS ARE FOR REFERENCE ONLY

| | |
|------------------|---------------------------|
| | |
| DAMAGE THRESHOLD | 50W/cm ² |
| EXTINCTION RATIO | 150:1 @ 3μm; 300:1 @ 15μm |
| PARALLELISM | ≤3 ARCMIN |
| SURFACE FLATNESS | λ/20 @ 10.6μm |
| SURFACE QUALITY | 60-40 |
| TRANSMISSION | >60% @ 2.5 - 12μm |



THIRD ANGLE
PROJECTION

ALL DIMS IN

mm

EO® **Edmund Optics®**

TITLE

Ø25mm, KRS-5, IR HOLOGRAPHIC WIRE GRID
POLARIZER

DWG NO

62774

SHEET
1 OF 1