

NOTES:

1. SUBSTRATE MATERIAL:
N-SF11
2. COATING (APPLY ACROSS CLEAR APERTURE)
- S1 & S2: MgF2 (400-700nm)
R(AVG) ≤1.75% @ 400 - 700nm

3. FINE GROUND SURFACE

4. RoHS COMPLIANT

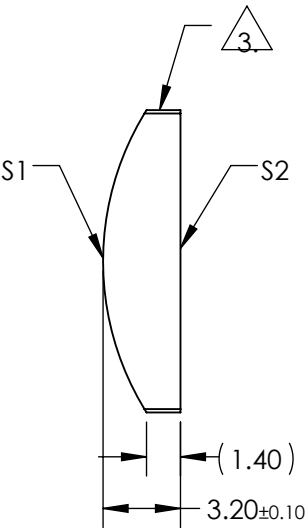
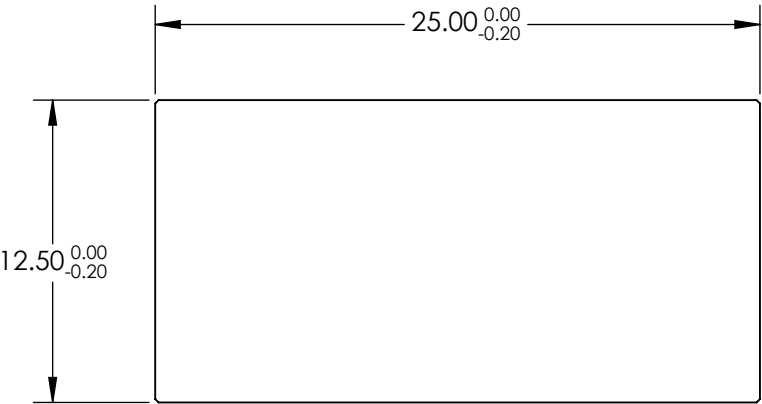

**FOR INFORMATION ONLY:
DO NOT MANUFACTURE
PARTS TO THIS DRAWING**

SPECIFICATIONS SUBJECT TO CHANGE WITHOUT NOTICE
DIMENSIONS ARE FOR REFERENCE ONLY

	S1	S2	EFL	15.00	 Edmund Optics®		
SHAPE	CONVEX	PLANO	BFL	13.21			
RADIUS	11.77	INFINITY			TITLE	12.5mm H X 25mm L X 15mm FL MGF2 COATED,CYLINDER LENS	
SURFACE QUALITY	60-40	60-40					
CLEAR APERTURE	11.50 x 24.00	11.50 x 24.00	ALL DIMS IN		DWG NO	68044	
BEVEL	PROTECTIVE AS NEEDED	PROTECTIVE AS NEEDED					
			mm				SHEET 1 OF 1