

NOTES:

- 1. SUBSTRATE  
SAPPHIRE (Al<sub>2</sub>O<sub>3</sub>)
- 2. SURFACE S2 TO BE PARALLEL WITH SURFACE S1 TO WITHIN 3.5 ARCMIN
- 3. COATING (APPLY ACROSS CLEAR APERTURE)  
  
S1: ¼ WAVE MgF<sub>2</sub> @ 550nm  
R(AVG) < 1.75% FROM 400-700nm (N-BK7)  
  
S2: ¼ WAVE MgF<sub>2</sub> @ 550nm  
R(AVG) < 1.75% FROM 400-700nm (N-BK7)

3. FINE GRIND SURFACE

- 4. POWER, IRREGULARITY, AND SURFACE QUALITY SPECIFICATIONS  
APPLY ACROSS CLEAR APERTURE
- 5. ROHS COMPLIANT

**FOR INFORMATION ONLY:  
DO NOT MANUFACTURE  
PARTS TO THIS DRAWING**

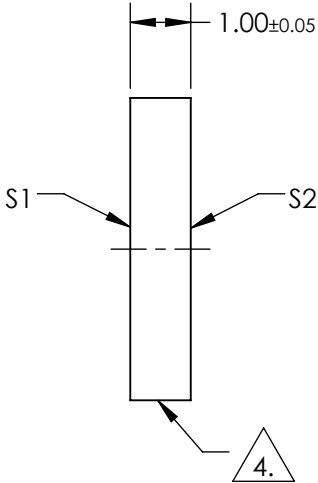
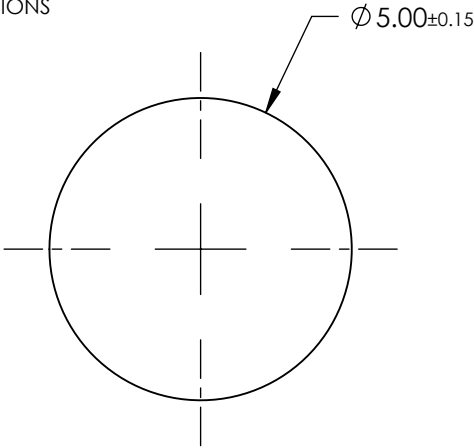

	S1	S2
SHAPE	PLANO	PLANO
CLEAR APERTURE	Ø4.5	Ø4.5
SURFACE FLATNESS	2λ	2λ
SURFACE ROUGHNESS	0.1 MICRONS PER INCH	0.1 MICRONS PER INCH
SURFACE QUALITY	80-50	80-50
BIREFRINGENCE (n <sub>o</sub> -n <sub>e</sub> )	0.008	0.008
BEVEL	PROTECTIVE AS NEEDED	PROTECTIVE AS NEEDED

SPECIFICATIONS SUBJECT TO CHANGE WITHOUT NOTICE  
DIMENSIONS ARE FOR REFERENCE ONLY

**Edmund Optics®**



ALL DIMS IN

mm

TITLE

5mm DIAMETER, MgF<sub>2</sub> COATED SAPPHIRE  
WINDOW

DWG NO

36197

SHEET  
1 OF 1