

NOTES:

- 1. SUBSTRATE:  
BK-7
- 2. CENTERING TOLERANCE (AT 587.6nm):  
BEAM DEVIATION (HALF ANGLE): <6 ARCMIN
- 3. COATING (APPLY ACROSS COATING APERTURE)  
S1: NONE  
S2: NONE

4. FINE GRINDE SURFACE

5. RoHS: COMPLIANT

FOR INFORMATION ONLY:  
DO NOT MANUFACTURE  
PARTS TO THIS DRAWING

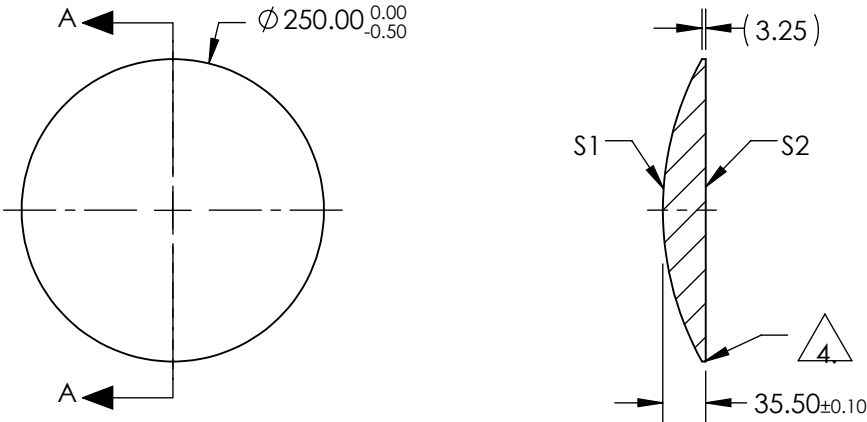

SECTION A-A

SPECIFICATIONS SUBJECT TO CHANGE WITHOUT NOTICE  
DIMENSIONS ARE FOR REFERENCE ONLY

REV. A	S1	S2	EFL: 500.00	 Edmund Optics®		
SHAPE	CONVEX	PLANO	BFL: 476.60			
RADIUS	258.40	∞		TITLE LARGE PCX CONDENSER LENS 250mm x 500mm		
SURFACE QUALITY	120-80	120-80				
CLEAR APERTURE	Ø245.00	Ø245.00				
BEVEL	PROTECTIVE AS NEEDED	PROTECTIVE AS NEEDED				
			ALL DIMS IN mm	DWG NO 67200	SHEET 1 OF 1	