

NOTES:

- 1. CONSTRUCTION:  
Anodized Aluminum Alloy, Burnished Spring Steel Leaves
- 2. NUMBER OF LEAVES: 15
- 3. OPERATING TEMPERATURE (°C): <250
- 4. ROHS: COMPLIANT

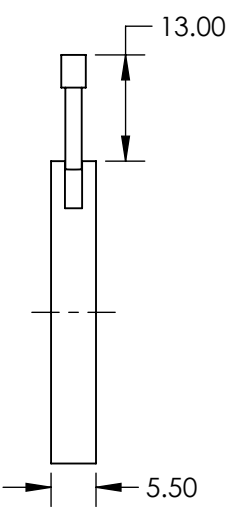
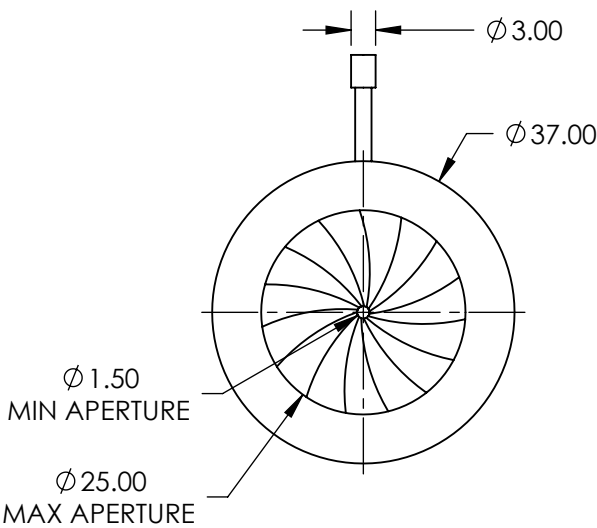

SPECIFICATIONS SUBJECT TO CHANGE WITHOUT NOTICE  
DIMENSIONS ARE FOR REFERENCE ONLY

**FOR INFORMATION ONLY:  
DO NOT MANUFACTURE  
PARTS TO THIS DRAWING**

**Edmund Optics®**

THIRD ANGLE PROJECTION		TITLE	37mm Outer Dia., Burnished Steel Leaves Iris Diaphragm	
ALL DIMS IN	mm	DWG NO	57582	SHEET 1 OF 1