

NOTES:

- 1. SUBSTRATE:
Fused Silica
- 2. COATING (APPLY ACROSS COATING APERTURE):
S1 & S2: NONE
- 3. EFFECTIVE FOCAL LENGTH: 5.10 mm
- 4. DIVERGENCE ANGLE: $\pm 1.6^\circ$
- 5. WAVELENGTH RANGE (nm): 200 - 2200
- 6. CLEAR APERTURE (mm): 9.00 x 9.00
- 7. ROHS: COMPLIANT

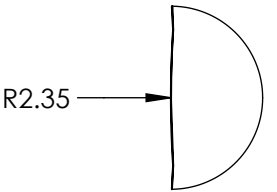

DETAIL A

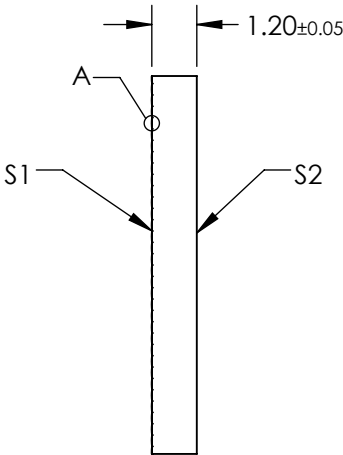
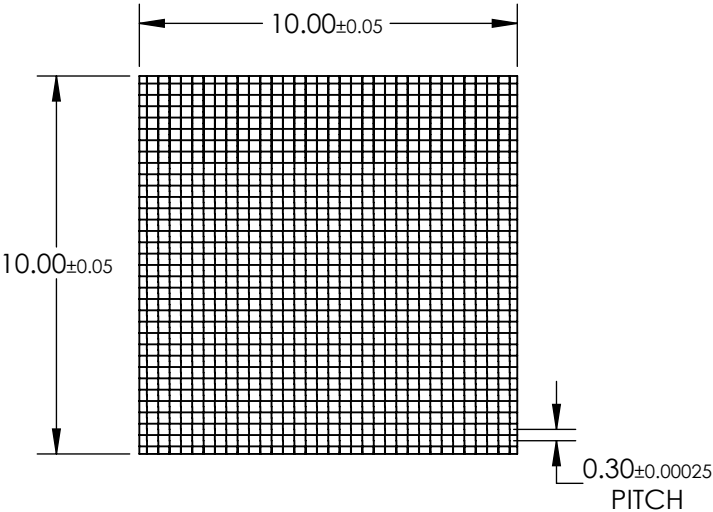

SPECIFICATIONS SUBJECT TO CHANGE WITHOUT NOTICE
DIMENSIONS ARE FOR REFERENCE ONLY

**FOR INFORMATION ONLY:
DO NOT MANUFACTURE
PARTS TO THIS DRAWING**

Edmund Optics®

THIRD ANGLE PROJECTION		TITLE	Microlens Array 10 x 10mm, 300µm Pitch, 1.6° Divergence	
ALL DIMS IN	mm	DWG NO	64476	SHEET 1 OF 1