

- NOTES:
- 1. SUBSTRATE:  
CHEMICALLY STRENGTHENED SCHOTT AS 87 eco
  - 2. COATING (APPLY ACROSS CLEAR APERTURE)  
  
S1 & S2: NONE
  - 3. ROHS COMPLIANT

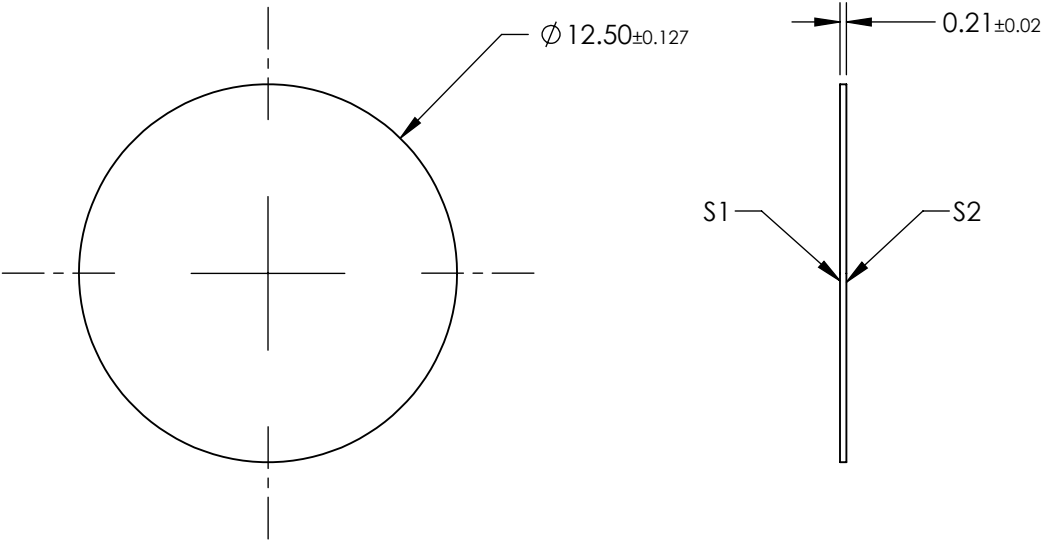
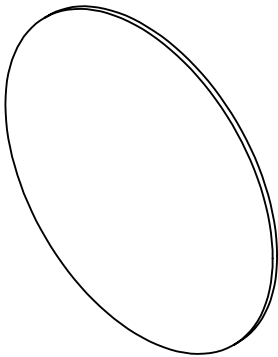

**FOR INFORMATION ONLY:**  
**DO NOT MANUFACTURE**  
**PARTS TO THIS DRAWING**

SPECIFICATIONS SUBJECT TO CHANGE WITHOUT NOTICE  
DIMENSIONS ARE FOR REFERENCE ONLY

	S1	S2
SHAPE	PLANO	PLANO
SURFACE QUALITY	80-50	80-50
CLEAR APERTURE	$\varnothing 11.25$	$\varnothing 11.25$
BEVEL	PROTECTED AS NEEDED	PROTECTED AS NEEDED

THIRD ANGLE  
PROJECTION

ALL DIMS IN      mm

 **Edmund Optics®**

TITLE	12.5mm Dia., 0.21mm Thick, Chemically Strengthened SCHOTT AS 87 eco Ultra-Thin Window		
DWG NO	22237	SHEET 1 OF 1	