

NOTES:

1. SUBSTRATE:
Calcium Fluoride, IR Grade (CaF₂)
2. CENTERING TOLERANCE: <3 ARCMIN
3. COATING (APPLY ACROSS CLEAR APERTURE)
- S1&S2: NONE
4. FINE GRIND SURFACE
5. FOCAL LENGTH TOLERANCE: ±2%
6. ROHS COMPLIANT

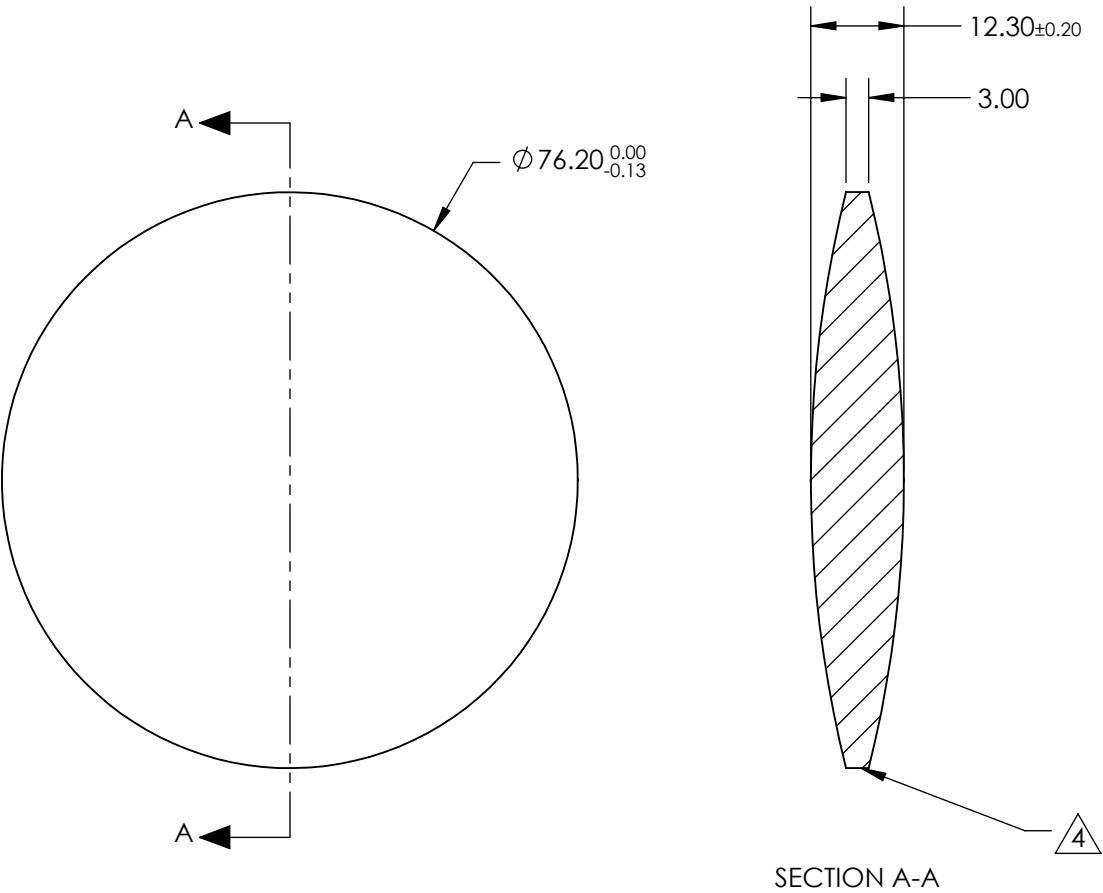

**FOR INFORMATION ONLY:
DO NOT MANUFACTURE
PARTS TO THIS DRAWING**

SPECIFICATIONS SUBJECT TO CHANGE WITHOUT NOTICE
DIMENSIONS ARE FOR REFERENCE ONLY

	S1	S2	5µm		Edmund Optics®		
SHAPE	CONVEX	CONVEX	BFL @ 5µm	195.49	 Edmund Optics®		
RADIUS	157.76	157.76					
IRREGULARITY AT 632.8nm	λ	λ		TITLE	76.2mm Dia. x 200mm FL, Uncoated, ISP Optics Calcium Fluoride (CaF2) DCX Lens		
SURFACE QUALITY	60-40	60-40					
CLEAR APERTURE	ø68.58	ø68.58					
BEVEL	PROTECTED AS NEEDED	PROTECTED AS NEEDED	ALL DIMS IN	mm	DWG NO	24775	SHEET 18 OF 20