

NOTES:

- 1. SUBSTRATE:  
Germanium (Ge)
- 2. CENTERING TOLERANCE:  
<3 ARCMIN
- 3. COATING (APPLY ACROSS CLEAR APERTURE)  
S1 & S2: NONE
- 4. FINE GRIND SURFACE
- 5. FOCAL LENGTH TOLERANCE: ±2%
- 6. ROHS COMPLIANT

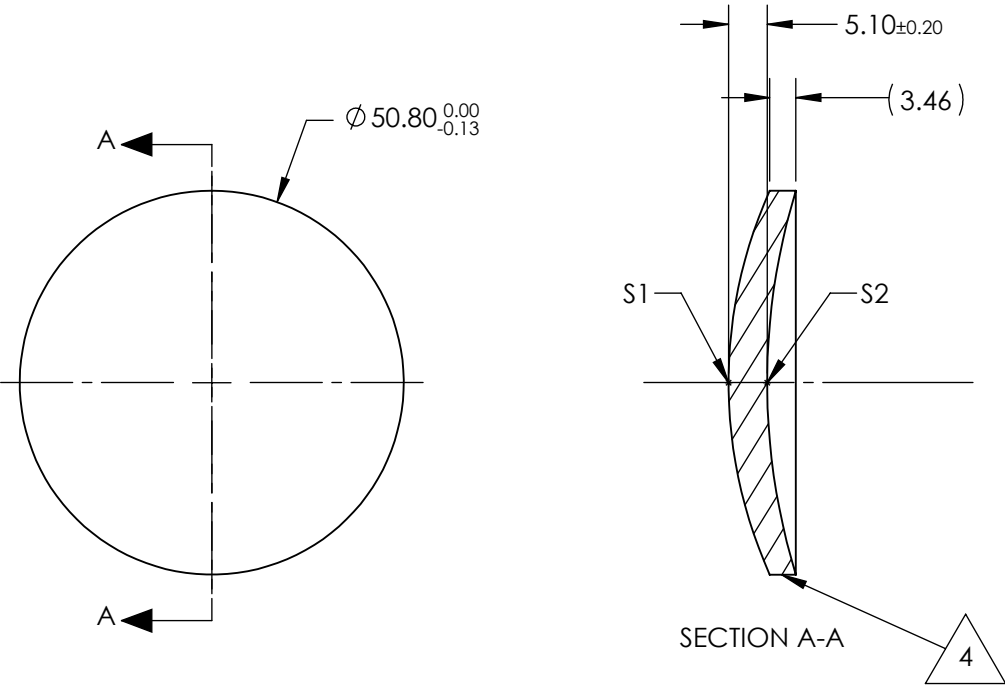

**FOR INFORMATION ONLY:  
DO NOT MANUFACTURE  
PARTS TO THIS DRAWING**

|                        | S1                  | S2                  |
|------------------------|---------------------|---------------------|
| SHAPE                  | CONVEX              | CONCAVE             |
| RADIUS                 | 61.94               | 86.7                |
| IRREGULARITY AT 10.6µm | λ/20                | λ/20                |
| SURFACE QUALITY        | 60-40               | 60-40               |
| CLEAR APERTURE         | ø45.72              | ø45.72              |
| BEVEL                  | PROTECTED AS NEEDED | PROTECTED AS NEEDED |

|                        |       |
|------------------------|-------|
| EFL @ 10.6µm           | 63    |
| BFL @ 10.6µm           | 58.68 |
| THIRD ANGLE PROJECTION |       |
| ALL DIMS IN            | mm    |

SPECIFICATIONS SUBJECT TO CHANGE WITHOUT NOTICE  
DIMENSIONS ARE FOR REFERENCE ONLY

**Edmund Optics®**

50.8mm Dia. x 63mm FL, Uncoated, ISP Optics  
Germanium (Ge) Meniscus Lens

DWG NO 24838

SHEET  
1 OF 1