

- NOTES:
- 1. SUBSTRATE:
Silicon (Si)
 - 2. CENTERING TOLERANCE:
EDGE THICKNESS VARIATION: <20µm
 - 3. COATING (APPLY ACROSS CLEAR APERTURE)

S1&S2: R(AVG) <0.5% @ 3 - 5µm
R(ABS) <1.5% @ 3 - 5µm

4. FINE GRIND SURFACE

5. SURFACE ROUGHNESS: <100 Ra

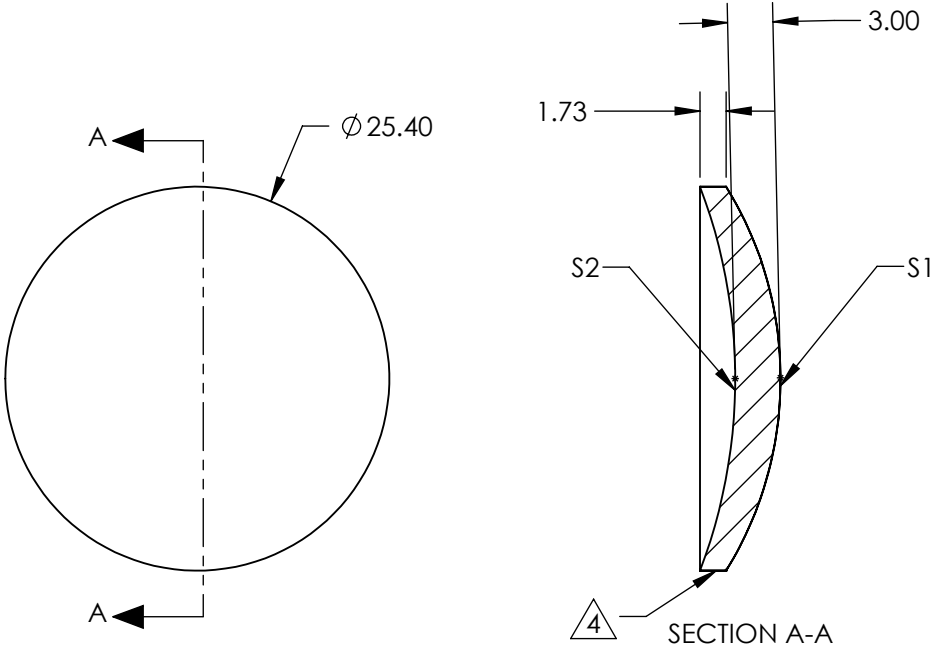

**FOR INFORMATION ONLY:
DO NOT MANUFACTURE
PARTS TO THIS DRAWING**

SPECIFICATIONS SUBJECT TO CHANGE WITHOUT NOTICE
DIMENSIONS ARE FOR REFERENCE ONLY

	S1	S2
SHAPE	CONVEX	CONCAVE
RADIUS	24.00	35.84
SURFACE QUALITY	60-40	60-40
CLEAR APERTURE	ø22.86	ø22.86
IRREGULARITY AT 632.8nm	λ/4	λ/4
BEVEL	PROTECTED AS NEEDED	PROTECTED AS NEEDED

THIRD ANGLE
PROJECTION

ALL DIMS IN mm

 **Edmund Optics®**

TITLE	25.4mm Dia. x 25.4mm FL, 3 - 5µm BBAR Coated, ISP Optics Silicon (Si) Aspheric Lens		
DWG NO	24885	SHEET 5 OF 19	