

NOTES:

1. SUBSTRATE MATERIAL:  
FUSED SILICA
2. SURFACE S2 TO BE PARALLEL TO SURFACE S1 TO WITHIN <3 ARCMIN
3. COATING (APPLY ACROSS CLEAR APERTURE)  
S1: DIELECTRIC  
R(AVG) ≥ 99.50% @ 532nm & 1064nm @ 45° AOI  
R(AVG) ≥ 80% @ 630 – 655nm @ 45° AOI
- S2: NONE

4. FINE GRIND SURFACE

5. POWER, IRREGULARITY, SURFACE QUALITY, AND COATING SPECIFICATIONS APPLY ACROSS CLEAR APERTURE
6. ROHS COMPLIANT

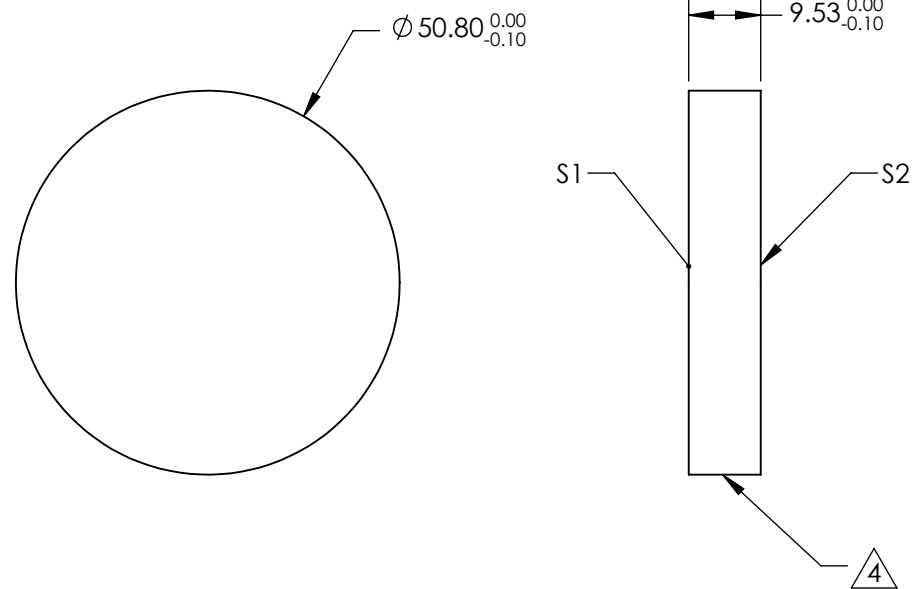
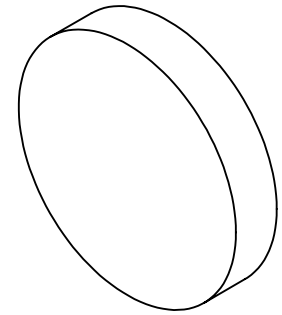

**FOR INFORMATION ONLY:  
DO NOT MANUFACTURE  
PARTS TO THIS DRAWING**

SPECIFICATIONS SUBJECT TO CHANGE WITHOUT NOTICE  
DIMENSIONS ARE FOR REFERENCE ONLY

	S1	S2
SHAPE	PLANO	PLANO
SURFACE FLATNESS	$\lambda/10$	N/A
SURFACE QUALITY	10 - 5	COMMERCIAL POLISH
CLEAR APERTURE	$\varnothing 11.43$	N/A
BEVEL	PROTECTED AS NEEDED	PROTECTED AS NEEDED



ALL DIMS IN

mm

**EO**® **Edmund Optics**®

TITLE

50.8mm Dia. x 9.53mm 532/630-655/1064nm,  
Dual Band Laser Mirror

DWG NO

26928

SHEET  
3 OF 3