

NOTES:

1. SUBSTRATE:

FUSED SILICA

2. S2 TO BE PARALLEL TO S1 TO WITHIN <3 ARMINIS

3. COATING (APPLY ACROSS CLEAR APERTURE)

S1 & S2: R(ABS) <0.25% @ 1030nm

DAMAGE THRESHOLD, BY DESIGN

15 J/cm² @ 1030nm, 20ns, 20Hz



4. FINE GRIND SURFACE

5. CLEAR APERTURE AND COATING APERTURE ARE CENTERED ON SURFACE

6. SURFACE QUALITY SPECIFICATIONS APPLY ACROSS CLEAR APERTURE

7. ROHS COMPLIANT

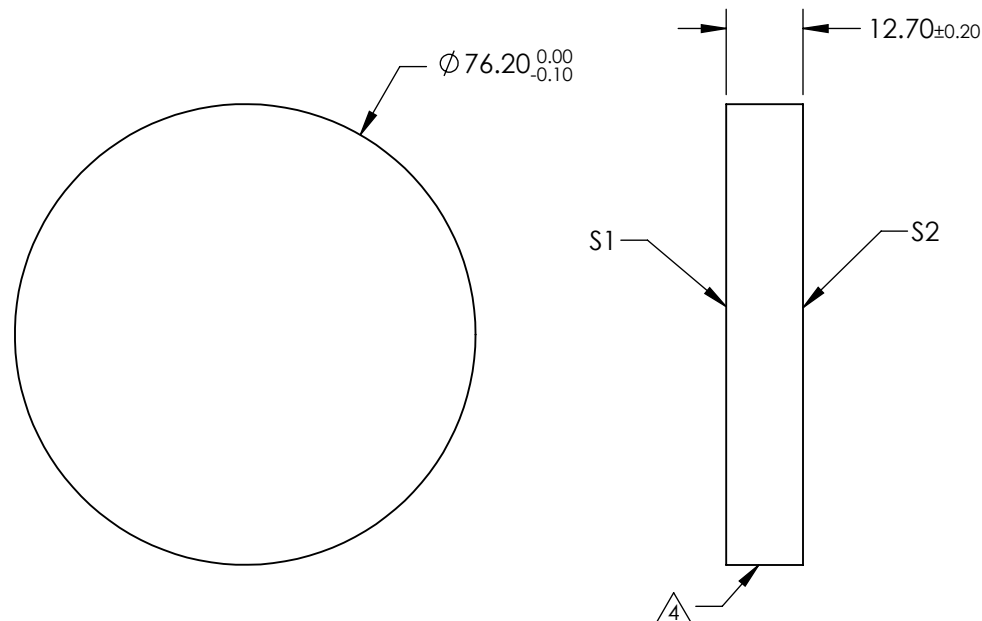
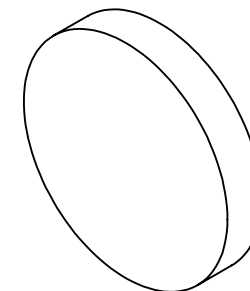

**FOR INFORMATION ONLY:
DO NOT MANUFACTURE
PARTS TO THIS DRAWING**

SPECIFICATIONS SUBJECT TO CHANGE WITHOUT NOTICE
DIMENSIONS ARE FOR REFERENCE ONLY

	S1	S2
SHAPE	PLANO	PLANO
SURFACE QUALITY	10 - 5	10 - 5
SURFACE FLATNESS	$\lambda/10$	$\lambda/10$
CLEAR APERTURE	Ø 68.58	Ø 68.58
BEVEL	PROTECTED AS NEEDED	PROTECTED AS NEEDED



ALL DIMS IN

mm



Edmund Optics®

TITLE

76.2mm Dia., 12.7mm Thick, 1030nm, $\lambda/10$
Fused Silica Window

DWG NO

27042

SHEET
3 OF 9