

NOTES:

- 1. SUBSTRATE:  
ZERODUR®
- 2. SURFACE S2 TO BE PARALLEL TO SURFACE S1 TO WITHIN 30 ARCSEC
- 3. COATING (APPLY ACROSS CLEAR APERTURE)  
S1: R(abs) >99.8% @ 355nm @ 45° AOI  
R(avg) >99.5% @ 351 - 358nm @ 45° AOI

DAMAGE THRESHOLD, BY DESIGN:  
6 J/cm² @ 355nm, 20ns, 20Hz

S2: NONE

4. FINE GRIND SURFACE

- 5. POWER, IRREGULARITY, AND SURFACE QUALITY SPECIFICATIONS APPLY  
ACROSS CLEAR APERTURE
- 6. CLEAR APERTURE AND COATING APERTURE ARE CENTERED ON SURFACES

**FOR INFORMATION ONLY:  
DO NOT MANUFACTURE  
PARTS TO THIS DRAWING**

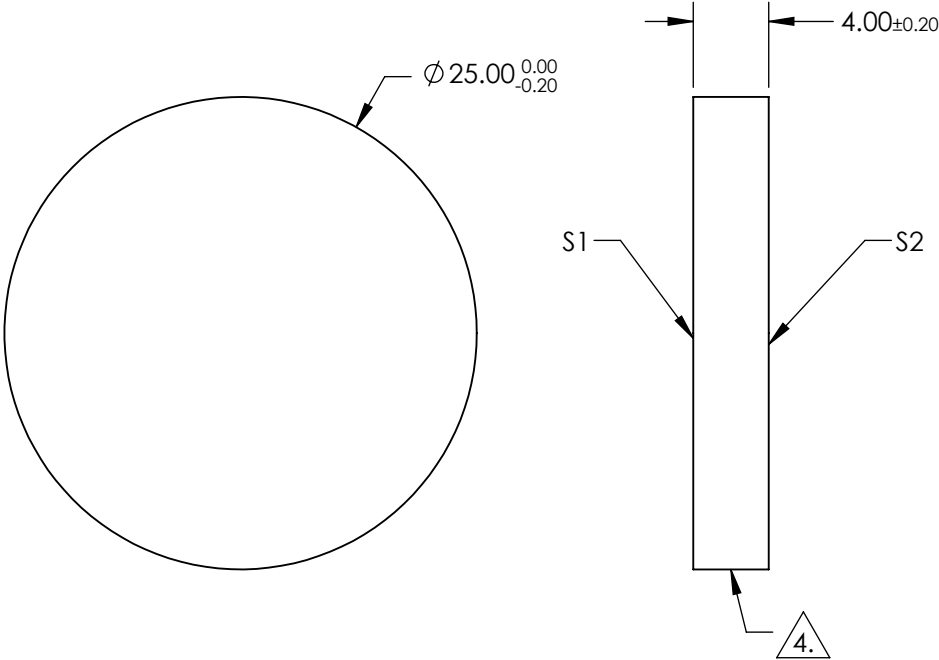

SPECIFICATIONS SUBJECT TO CHANGE WITHOUT NOTICE  
DIMENSIONS ARE FOR REFERENCE ONLY

	S1	S2
SHAPE	PLANO	PLANO
SURFACE QUALITY	20-10	COMMERCIAL POLISH
CLEAR APERTURE	Ø 22.50	N/A
COATING APERTURE	Ø 22.50	N/A
BEVEL	PROTECTED AS NEEDED	PROTECTED AS NEEDED

 Edmund Optics®			
THIRD ANGLE PROJECTION 		TITLE	25mm Dia. 355nm 45°, Nd:YAG Laser Line Mirror
ALL DIMS IN	mm	DWG NO	26417
			SHEET 12 OF 86