

NOTES:

1. SUBSTRATE:
ZERODUR®
2. SURFACE S2 TO BE PARALLEL TO SURFACE S1 TO WITHIN 30 ARCSEC
3. COATING (APPLY ACROSS CLEAR APERTURE)
S1: R(abs) >99.8% @ 532nm @ 45° AOI
R(avg) >99.5% @ 523 - 537nm @ 45° AOI
- DAMAGE THRESHOLD, BY DESIGN:
15 J/cm² @ 532nm, 20ns, 20Hz
- S2: NONE
4. FINE GRIND SURFACE
5. POWER, IRREGULARITY, AND SURFACE QUALITY SPECIFICATIONS APPLY
ACROSS CLEAR APERTURE
6. CLEAR APERTURE AND COATING APERTURE ARE CENTERED ON SURFACES

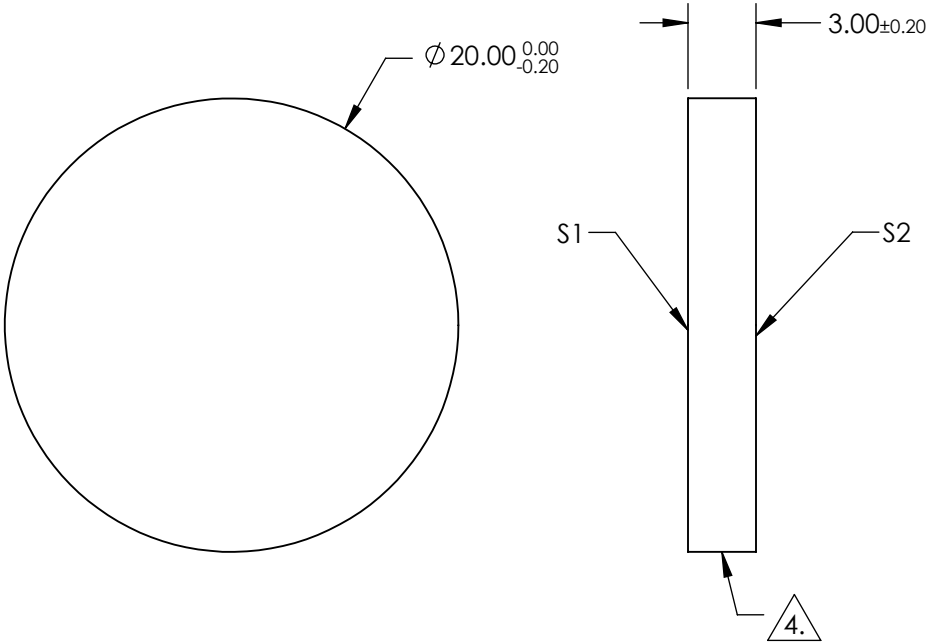
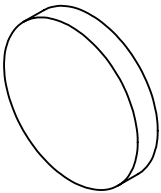

**FOR INFORMATION ONLY:
DO NOT MANUFACTURE
PARTS TO THIS DRAWING**

SPECIFICATIONS SUBJECT TO CHANGE WITHOUT NOTICE
DIMENSIONS ARE FOR REFERENCE ONLY

	S1	S2	<div><div><div><div><div></div><div></div></div><div></div></div><div>Edmund Optics®</div></div><div><div>THIRD ANGLE PROJECTION</div><div></div></div><div><div>TITLE</div><div>20mm Dia. 532nm 45°, Nd:YAG Laser Line Mirror</div></div><div><div>ALL DIMS IN</div><div>mm</div></div><div><div>DWG NO</div><div>26426</div></div><div><div>SHEET</div><div>15 OF 86</div></div></div>			
SHAPE	PLANO	PLANO				
SURFACE QUALITY	20-10	COMMERCIAL POLISH				
CLEAR APERTURE	Ø 18.00	N/A				
COATING APERTURE	Ø 18.00	N/A				
BEVEL	PROTECTED AS NEEDED	PROTECTED AS NEEDED				