

NOTES:

- 1. SUBSTRATE:
ZERODUR®
- 2. SURFACE S2 TO BE PARALLEL TO SURFACE S1 TO WITHIN 30 ARCSEC
- 3. COATING (APPLY ACROSS CLEAR APERTURE)
S1: R(abs) >99.8% @ 1064nm @ 45° AOI
R(avg) >99.5% @ 1046 - 1074nm @ 45° AOI

DAMAGE THRESHOLD, BY DESIGN:
20 J/cm² @ 1064nm, 20ns, 20Hz

S2: NONE

4. FINE GRIND SURFACE

- 5. POWER, IRREGULARITY, AND SURFACE QUALITY SPECIFICATIONS APPLY
ACROSS CLEAR APERTURE
- 6. CLEAR APERTURE AND COATING APERTURE ARE CENTERED ON SURFACES

**FOR INFORMATION ONLY:
DO NOT MANUFACTURE
PARTS TO THIS DRAWING**

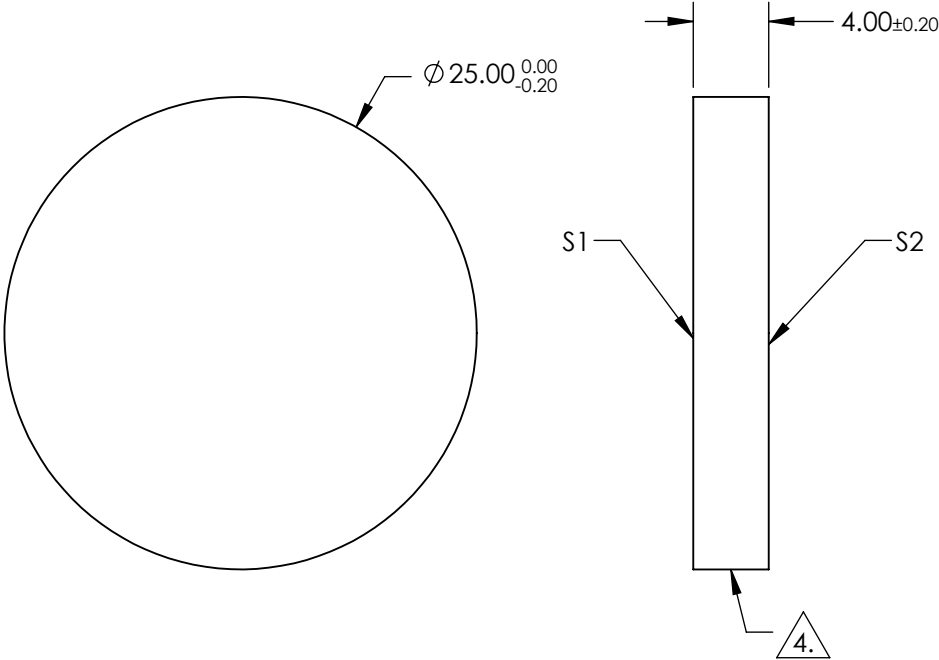

SPECIFICATIONS SUBJECT TO CHANGE WITHOUT NOTICE
DIMENSIONS ARE FOR REFERENCE ONLY

	S1	S2
SHAPE	PLANO	PLANO
SURFACE QUALITY	20-10	COMMERCIAL POLISH
CLEAR APERTURE	Ø 22.50	N/A
COATING APERTURE	Ø 22.50	N/A
BEVEL	PROTECTED AS NEEDED	PROTECTED AS NEEDED

THIRD ANGLE PROJECTION		Edmund Optics®	
TITLE		25mm Dia. 1064nm 45°, Nd:YAG Laser Line Mirror	
ALL DIMS IN	mm	DWG NO	26437
			SHEET 20 OF 86