

NOTES:

- 1. SUBSTRATE:  
FUSED SILICA (CORNING 7980)
- 2. SURFACE S2 TO BE PARALLEL TO S1 WITHIN <5 ARCSEC
- 3. COATING (APPLY ACROSS CLEAR APERTURE)

S1 & S2: NONE

4. FINE GRIND SURFACE

5. ROHS COMPLIANT

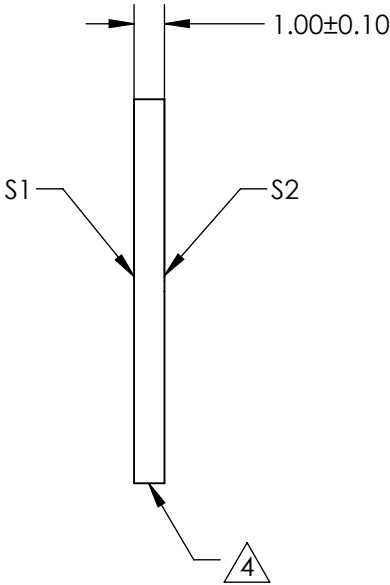
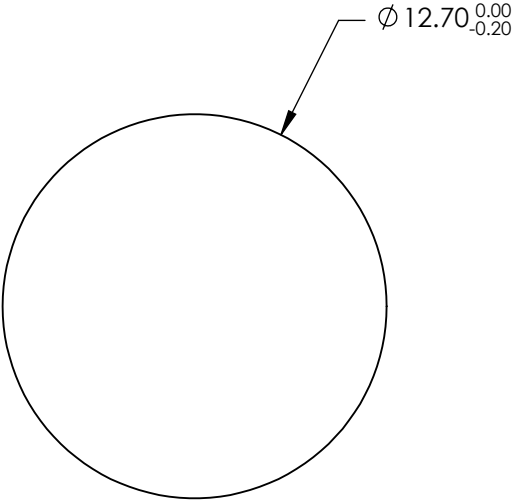
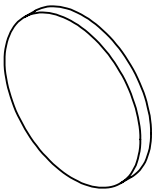

**FOR INFORMATION ONLY:  
DO NOT MANUFACTURE  
PARTS TO THIS DRAWING**

SPECIFICATIONS SUBJECT TO CHANGE WITHOUT NOTICE  
DIMENSIONS ARE FOR REFERENCE ONLY

|                 |                     |                     |                           |    |                |  |                 |
|-----------------|---------------------|---------------------|---------------------------|----|----------------|--|-----------------|
|                 | S1                  | S2                  |                           |    | Edmund Optics® |  |                 |
| SHAPE           | PLANO               | PLANO               | THIRD ANGLE<br>PROJECTION |    | TITLE          | 12.7mm Dia., 1mm Thick, Uncoated, λ/10 IR<br>Fused Silica Window |                 |
| SURFACE QUALITY | 20 - 10             | 20 - 10             |                           |    |                |  |                 |
| CLEAR APERTURE  | Ø 11.43             | Ø 11.43             |                           |    |                |  |                 |
| BEVEL           | PROTECTED AS NEEDED | PROTECTED AS NEEDED | ALL DIMS IN               | mm | DWG NO         | 70103  | SHEET<br>1 OF 9 |