

NOTES:

- 1. SUBSTRATE:  
FUSED SILICA (CORNING 7980)
- 2. S1 TO BE PARALLEL WITH S2 TO WITHIN <1 ARCMIN
- 3. COATING (APPLY ACROSS CLEAR APERTURE)  
S1 & S2: VIS-NIR (400-1000nm)  
R(ABS) ≤0.25% @ 880nm  
R(AVG) ≤1.25% @ 400 - 870nm  
R(AVG) ≤1.25% @ 890 - 1000nm
- 4. FINE GRIND SURFACE
- 5. ROHS COMPLIANT

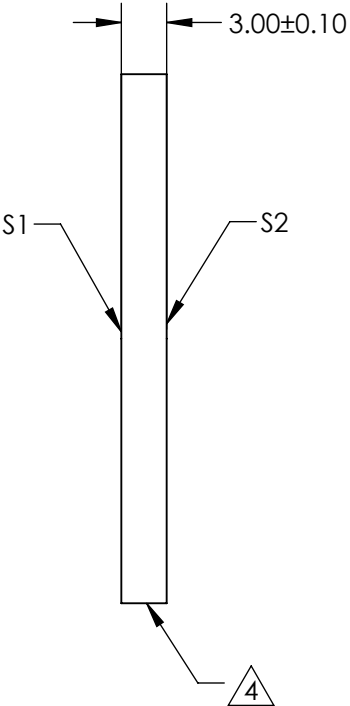
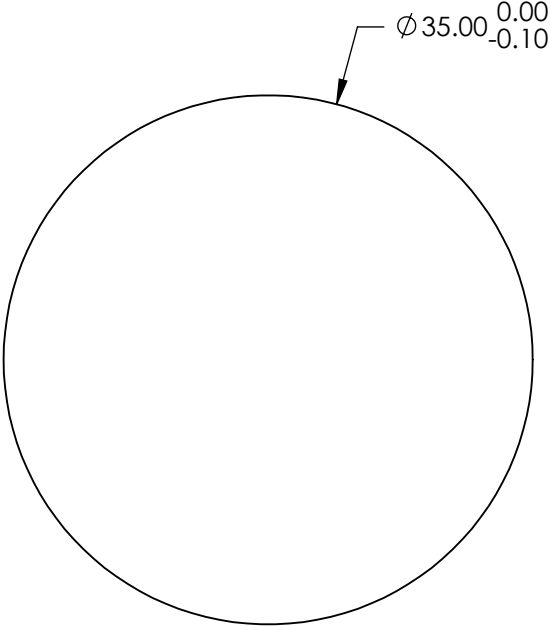
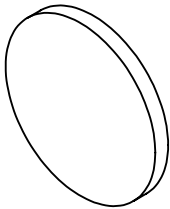

**FOR INFORMATION ONLY:  
DO NOT MANUFACTURE  
PARTS TO THIS DRAWING**

SPECIFICATIONS SUBJECT TO CHANGE WITHOUT NOTICE  
DIMENSIONS ARE FOR REFERENCE ONLY

	S1	S2
SHAPE	PLANO	PLANO
SURFACE QUALITY	40 - 20	40 - 20
CLEAR APERTURE	Ø 31.50	Ø 31.50
BEVEL	PROTECTED AS NEEDED	PROTECTED AS NEEDED

THIRD ANGLE PROJECTION

ALL DIMS IN mm

**Edmund Optics®**

TITLE	35mm Dia., 3mm Thick, VIS-NIR Coated, λ/4 Fused Silica Window		
DWG NO	72394	SHEET 54 OF 84	