

NOTES:

- 1. SUBSTRATE:
N-BK7
- 2. COATING (APPLY ACROSS CLEAR APERTURE)

S1 & S2: BBAR (1650-3000nm)
R(AVG) <1% FROM 1650 - 3000nm @ 0° AOI
R(ABS) <2% FROM 1650 - 3000nm @ 0° AOI
- 3. FINE GRIND SURFACE
- 5. POWER, IRREGULARITY, AND SURFACE QUALITY SPECIFICATIONS
APPLY ACROSS CLEAR APERTURE
- 6. FOCAL LENGTH (EFL): 75.00mm±1%
BACK FOCAL LENGTH (BFL): 67.78mm
- 7. ROHS COMPLIANT

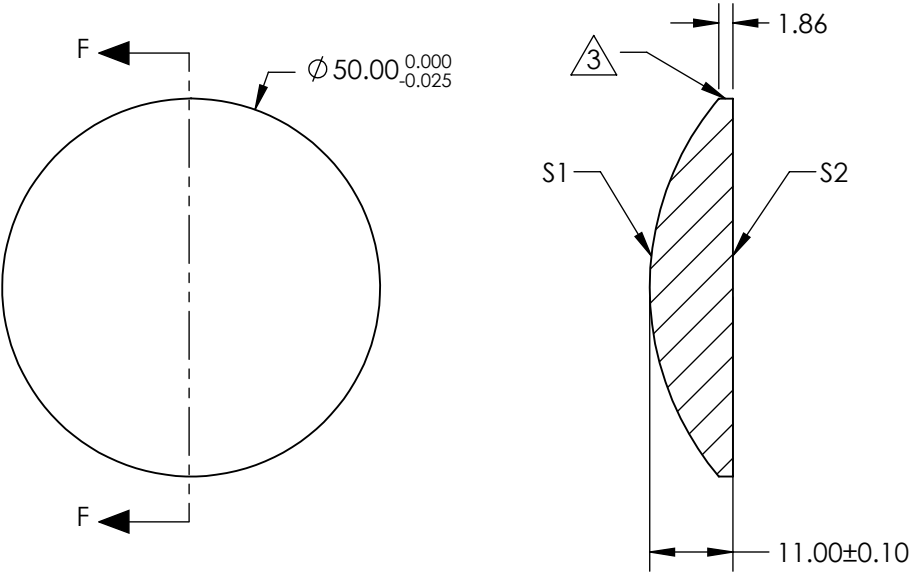

**FOR INFORMATION ONLY:
DO NOT MANUFACTURE
PARTS TO THIS DRAWING**

	S1	S2
SHAPE	CONVEX	PLANO
RADIUS	38.76	INFINITY
SURFACE QUALITY	40 - 20	40 - 20
CLEAR APERTURE	Ø 45.00	Ø 45.00
POWER AT 632.8nm	3.00 RINGS	3.00 RINGS
IRREGULARITY AT 632.8nm	0.50 RINGS	0.50 RINGS
BEVEL	PROTECTED AS NEEDED	PROTECTED AS NEEDED

SPECIFICATIONS SUBJECT TO CHANGE WITHOUT NOTICE
DIMENSIONS ARE FOR REFERENCE ONLY

Edmund Optics®

THIRD ANGLE PROJECTION	TITLE	50mm Dia. x 75mm FL, SWIR Coated N-BK7 PCX Lens	
		DWG NO	70275
ALL DIMS IN	mm	SHEET 11 OF 15	