

NOTES:

1. SUBSTRATE:
N-BK7

2. COATING (APPLY ACROSS CLEAR APERTURE)

S1 & S2: BBAR (1650-3000nm)
R(AVG) <1% FROM 1650 - 3000nm @ 0° AOI
R(ABS) <2% FROM 1650 - 3000nm @ 0° AOI

3. FINE GRIND SURFACE

5. POWER, IRREGULARITY, AND SURFACE QUALITY SPECIFICATIONS
APPLY ACROSS CLEAR APERTURE

6. FOCAL LENGTH (EFL): 150.00mm±1%
BACK FOCAL LENGTH (BFL): 144.14mm

7. ROHS COMPLIANT

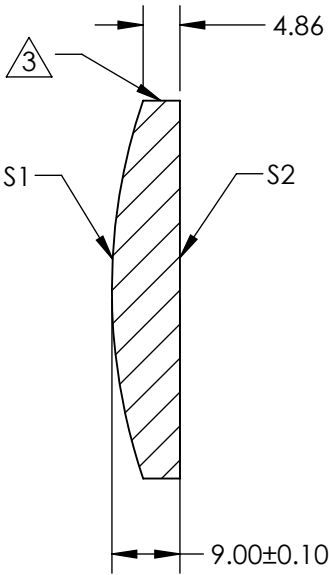
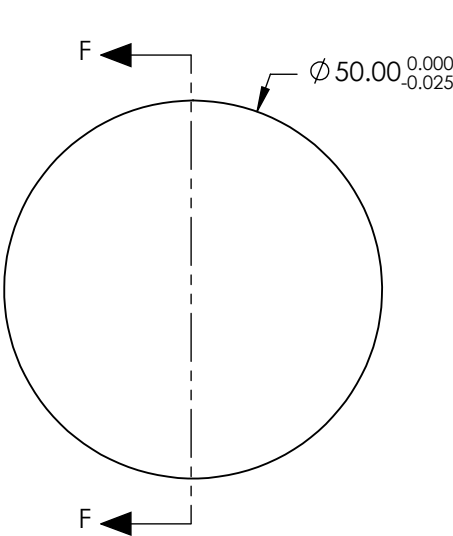

**FOR INFORMATION ONLY:
DO NOT MANUFACTURE
PARTS TO THIS DRAWING**

	S1	S2
SHAPE	CONVEX	PLANO
RADIUS	77.52	INFINITY
SURFACE QUALITY	40 - 20	40 - 20
CLEAR APERTURE	Ø 45.00	Ø 45.00
POWER AT 632.8nm	3.00 RINGS	3.00 RINGS
IRREGULARITY AT 632.8nm	0.50 RINGS	0.50 RINGS
BEVEL	PROTECTED AS NEEDED	PROTECTED AS NEEDED

SPECIFICATIONS SUBJECT TO CHANGE WITHOUT NOTICE
DIMENSIONS ARE FOR REFERENCE ONLY

Edmund Optics®



ALL DIMS IN

mm

TITLE

50mm Dia. x 150mm FL, SWIR Coated N-BK7
PCX Lens

DWG NO

70278

SHEET
14 OF 15